

SAFETY DEVICES

- **Overload detector**, stops movement in case of overload.
- **Electromagnetic brake**, brakes the motor shaft when it is not in tension.
- **Thermal probe**, protects the motor in case of overheating.
- **Upper limit switch**, stops the movement of ascent.
- **Cable absence limit switch**, detects when there's no more cable left inside the winder.
- **Emergency descent**, allows the descent in case of power failure.
- **Centrifugal brake**, Keeps constant the speed of emergency descent.
- **Work rope**, with a 50kN breaking load
- **Safety coefficient of the wire ropes**
- **Manual elevation emergency system**

TECHNICAL INFO

Motorized tripod ideal for safe work in confined spaces with access from a vertical manhole where there is no ladder or equivalent access system.

It is a safe and certified equipment for lifting people, with CE marking, and does not require vertical work training to be used.

To ensure the safety of individuals, it uses an electric hoist with a manual rescue option in case of an electrical system failure. Additionally, it features a double fall arrest system to provide a higher level of safety in the event of a lifting cable failure.

TECHNICAL CHARACTERISTICS

Load capacity in harness, chair, or cradle	120kg
Maximum number of people in harness, chair, or cradle	1 person
Maximum working depth from tripod	40m
Maximum cable length	80m (cable length must be, at least, 2 x working depth from tripod)
Lifting and lowering speed	4m/min
Electrical power supply	Three-phase 380-400V/50-60Hz Three-phase 220-240V/50-60Hz
Total power	0.75kW
Electrical connection	16A (3P+N+T)
Control stations	Main on harness, chair, or cradle (control pendant, radio remote control, or ATEX radio remote control) Secondary or rescue at tripod level (standard control pendant)
Rescue options	Electric rescue using secondary control station. Manual rescue using handle.
Disassemblable	YES
Certified EN795 anchorage points	1 unit in double safety device system 3 units on tripod

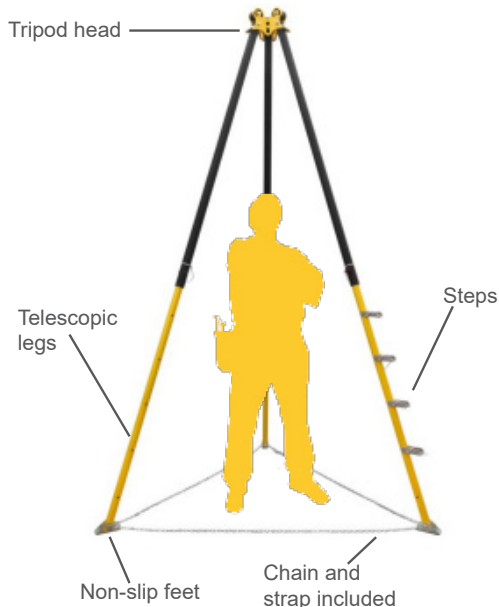
**TRIPOD
OR SUSPENSION STRUCTURE**

TECHNICAL INFO
Tripod

Tripod for a working height range from 1.95 to 3.11 m.

Equipped with 3 built-in pulleys in the tripod head, 3 anchorage points on the head, telescopic legs with 9 possible adjustment points and steps, non-slip feet, and included chain or strap for securing the legs.

Characteristics

Material	Aluminum alloy
Height	From 1.95 up to 3.11m
Leg opening diameter	From 1.12 up to 1.74m
Leg span	From 0.96 up to 1.5m
Carrying box dimensions	2300x375x330
Weight	28.7kg

Versions

	Main control station: Control pendant 40m	Main control station: Standard radio remote control	Main control station: ATEX radio remote control
Three-phase 380-400V /50-60Hz	200034004B	200034004R	200034004A
Three-phase 220-240V /50-60Hz	200034002B	200034002R	200034002A

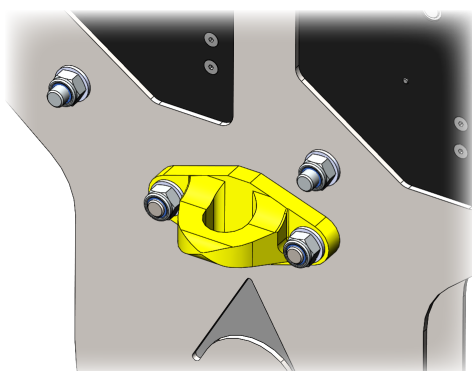

PAF150

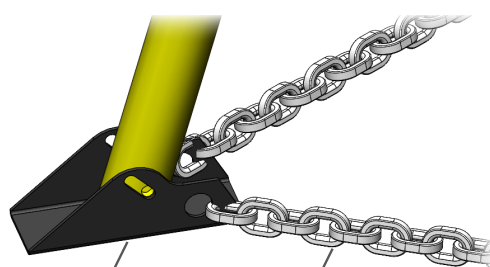
 Non-slip rubber
outsole

Safety chain

Advantages

- Simple, safe, and comfortable.
- Easy to store, transport, and assemble.
- Manageable and user-friendly.
- Manhole pass-through (500 mm).
- Integrated fall protection system.
- Lightweight and ergonomic.
- Automatic cable pass-through.
- Constant lifting force and speed.
- Suitable for personnel without vertical work certification (training in working at heights and in confined spaces).
- CE marked and certified according to Directive 2006/42/EC.

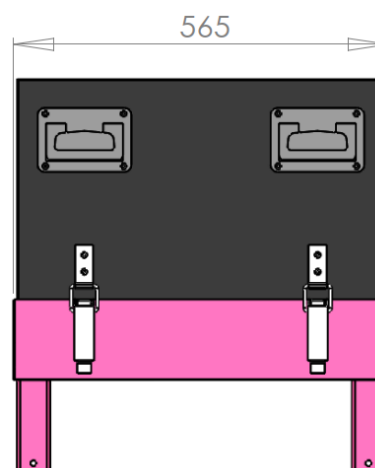
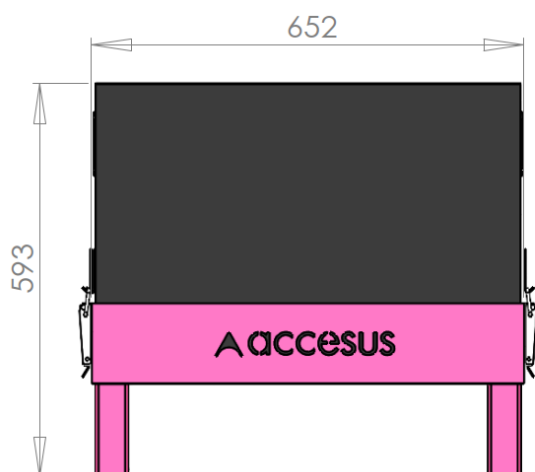
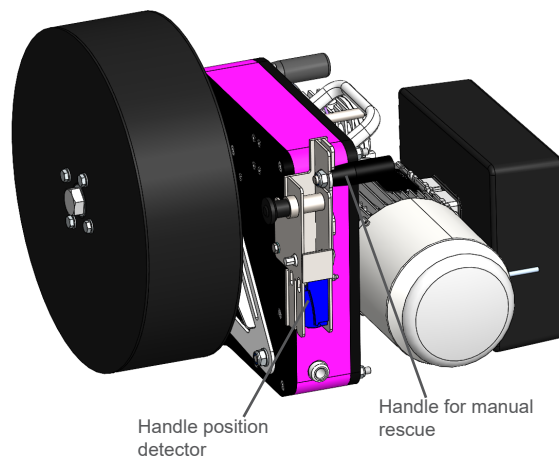
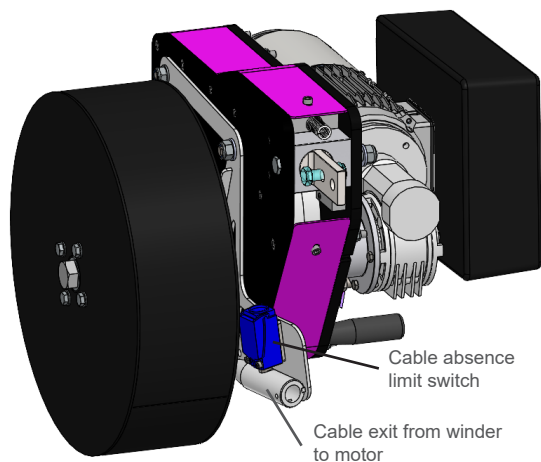

Electrical equipment



Selector for RPM1/
PM2 control station
(key)

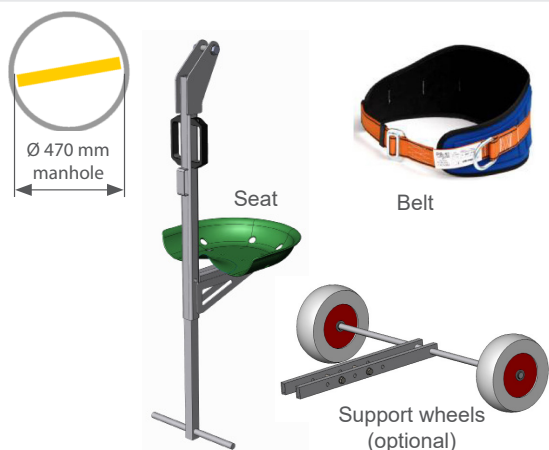

WORK SEAT

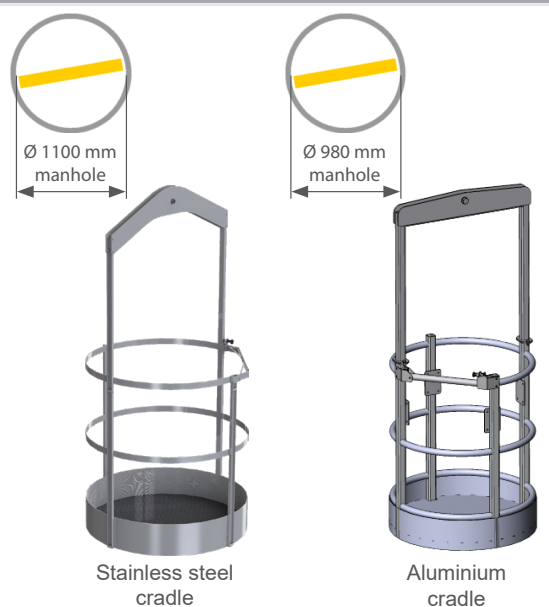

ROUNDED SUSPENDED CRADLES



SUSPENSION HARNESS

Weights	
Component	Weight
Tripod	28.7kg
LEVA hoist + cable winder	43kg
Double safety device system	25kg
Chair	10kg
Circular cradle NOX	60kg
Rectangular cradle	90kg
Aluminum circular cradle	45kg

Suspended work seats & cradles available:

- **Suspended work seat** with belt & detachable support wheels (optional). Unassembled passes into Ø 470 mm manholes (max dimension 415 mm).
- **Rectangular suspended cradle detachable.** Available in **0.80, 1.20 or 1.60 m** length. Unassembled passes into Ø 700 mm manholes (max dimension 640 mm).
- **Rounded suspended cradle.** Available in **stainless steel** Ø1.04 m (chemical plants...) or made of **aluminium** Ø0.92 m (lightweight). Unassembled passes into Ø 1.100 mm manholes (max dimension 1.040 mm) or Ø 980 mm manholes (max dimension 920 mm).
- **Suspension harness** meeting EN361, EN358, EN813 standards.

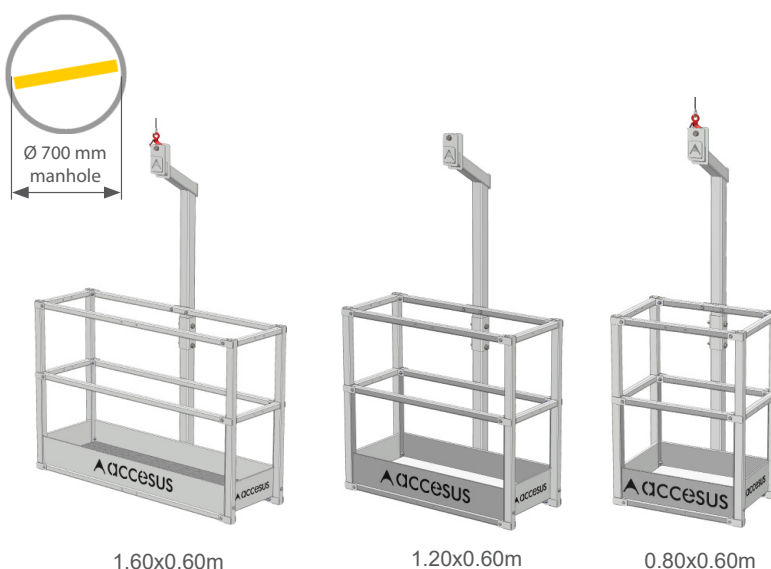

RECTANGULAR SUSPENDED CRADLES

